

KPDA Media Weekly Review Report as at 30th August 2020



CEO DE-BRIEF

KPDA Platinum Members
KPDA
KENYA PROPERTY DEVELOPERS ASSOCIATION

ALN
Anjarwalla & Khana Advocates

BA
Balala & Abed Advocates

FUSION CAPITAL
Rooted in the African growth story
Fusion Capital Ltd

MI VIDA
MY HOME, MY LIFE
Prism Residential Ltd

HFDI
Dreams Made Possible
HF Development and Investments Ltd

NCBA
NCBA Bank Kenya PLC

NEWLINE
Office Furniture & Kitchens
Newline Ltd

YASIAN Interiors
Living with Quality
Yasian Technology Company td

TWO RIVERS
Two Rivers Development Ltd

SYMBION
Symbion Kenya Ltd

SAVANNAH CEMENT
Building Perfection
Savannah Cement Ltd

KCB
Making the Difference
KCB Bank Kenya Ltd

MRM
MABATI ROLLING MILLS
Mabati Rolling Mills Ltd

KONE
Elevators Escalators
Kone Kenya Ltd

Britam
With you every step of the way
Britam Asset Managers

From the evidence so far, the new coronavirus can be transmitted in ALL AREAS, including areas with hot and humid weather.

Regardless of climate, adopt protective measures if you live in, or travel to an area reporting COVID-19.

The best way to protect yourself against COVID-19 is by frequently cleaning your hands. Eliminate viruses that may be on your hands and avoid infection that could occur by then touching your eyes, mouth, and nose.

FACT:
The new coronavirus can be transmitted in areas with hot and humid climates

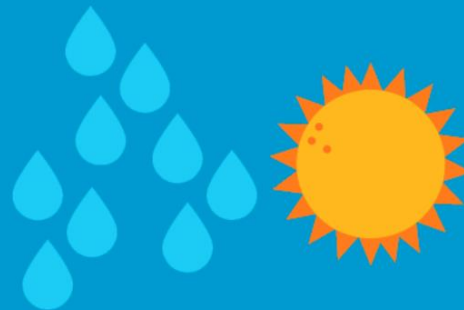

ADVERTISE WITH US: WE ARE GIVING YOU AN 80% DISCOUNT!!!!

KPDA
KENYA PROPERTY DEVELOPERS ASSOCIATION

ADVERTISE WITH KPDA AT AN 80% DISCOUNT!

Why Advertise through KPDA Media

Your Ad will run on these platforms:

- ★ The KPDA Website
- ★ The KPDA Media Weekly Review Reports
- ★ KPDA Social Media Platforms: Facebook, Twitter and LinkedIn
- ★ KPDA's Email Listing

AD Requirements:

- ★ JPG or PNG format
- ★ 72 dpi resolution
- ★ Colour calibration RGB
- ★ Size should not exceed 30KB

Advertising Terms and Conditions

- Advertisements will only be run upon receipt of payment
- All information and Material supplied to KPDA should be true, accurate and not misleading, and nothing contained in it is liable to bring KPDA into disrepute
- The Material shall not indicate an intention to discriminate on grounds of sex, race, religion or belief, disability, ethnic origin, age or sexual orientation (unless such an Advertisement is exempted from any statutory requirements relating to such forms of discrimination and the Customer notifies KPDA of the applicability of such an exemption at the time when the Advertisement is submitted to KPDA);
- KPDA reserves the right to determine the appropriateness of ad content and not run advertisements deemed to contract KPDA's Code of Conduct and values. In the event that KPDA declines to run an advertisement, the customer shall be refunded for the amount they will have paid.

What is the Cost of Advertising with KPDA?

We will run your ad for a period of four (4) weeks (one month) at an 80% discount!!!

- **KPDA Members:-**
Kshs. 3, 420 VAT Incl
- **Non-Members:-**
Kshs. 5, 700 VAT Incl

Payment must be received prior to the commencement of advertising. An invoice shall be issued upon confirmation to facilitate the processing of payment.

KPDA Advertising Platform Statistics

The KPDA Website - www.kpda.or.ke:

- 10, 000 visitors per month
- 7, 000 visitors on Mondays and Wednesdays

The KPDA Media Weekly Review Report

- Over 1, 500 subscribers
- An organic reach of over 500 subscribers

Facebook page - Kenya Property Developers Association:

- 3, 360 followers and 3, 232 likes
- An organic reach of over 1, 500

KPDA on Twitter @KPDA_Ke:

- 5, 040 followers
- 14, 000 impressions per month

LinkedIn - Kenya Property Developers Association:

- 2, 732 followers
- Over 500 views per day

Email Contacts - ceo@kpda.or.ke, membership@kpda.or.ke, kpdasecretariat@gmail.com

- Over 1, 000 email contacts

For more information,
please call: 0725 286 689 / 0737 530 290
or email: ceo@kpda.or.ke

www.kpda.or.ke
KPDA_Ke
Kenya Property Developers Association
Kenya Property Developers Association

Reach out to us on ceo@kpda.or.ke. Click [here](#) to view the flyer

CO-WORKING SPACE AVAILABLE!!! - BOOGERTMAN+PARTNERS

With Kshs. 100, 000 at Allianz Plaza, Riverside drive, Boogertman +Partners is letting you an office space and the following amenities are inclusive of the price:

- Concierge services including mail handling and receptionist services.
- Use of Connect Coffee lounge and of the private member all weather terrace for informal meetings, breakout and collaboration areas featuring relaxed contemporary seating designed to encourage interaction.
- Use of board rooms featuring state of the art technology for 8 hours a month. Use of board rooms beyond this is chargeable at a member rate of \$30 + VAT per hour.
- 24-hour access.
- Grade A building featuring secure access, 3 high speed lifts, fire suppression, backup generator, back up and water supply.
- Member self-serve kitchen offering unlimited tea, coffee & water.
- High speed secure Wi-Fi.

Contact them at margaret@boogertman.co.ke or call +254 736 399 361/ +254 204 408 990

For more information, please click [HERE](#)

ALLIANZ PLAZA, RIVERSIDE DRIVE

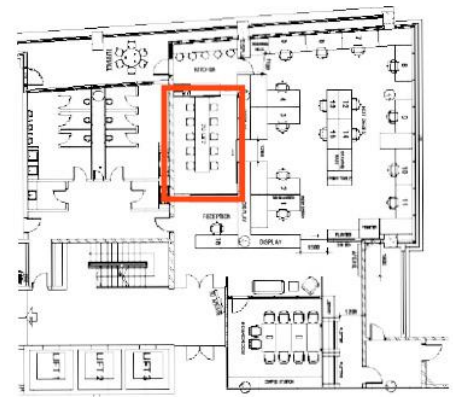

96 RIVERSIDE DRIVE, RIVERSIDE

Shared Office space

- + Nett Rentable Area: 25sqm
- + High Speed Internet
- + High Touch concierge reception services
- + Storage Shelves Available
- + Accessible private Terrace

KES 100,000 Per Month

For more info contact:
+254 736 399 367 / +254 204 408 990
mail@boogertman.co.ke

Boogertman
Partners
Architects LTD

KPDA CONSTRUCTION, REAL ESTATE AND LAND SECTOR COVID 19 UPDATES

Please find the attached presentation for your updates. The update this time **does not necessarily** have to be on [Presentation](#) COVID 19 you can add any advocacy issue.

Three first three slides are similar. The parts are described as follows

1. Jobs - this details what the sector is doing to retain jobs.
2. Business - this details what the sector is doing to ensure business continuity
3. Health Support - this details what the sector is doing to support the health sector in terms of COVID 19
4. Government- this is the programmes that the sector is working jointly with government or have achieved through engagement with government.

Kindly add new updates in the 2nd slides and where possible add numbers and statistics

The other slide focuses on the issues you are facing and the action/s or commitment/s that have been made to address the issue. If there is a new challenge that you would like addressed, kindly add them in this slide. You can also add the status of each issue so far.

Kindly forward your input by Close of Business **Tuesday, 1st September 2020.**

30th August 2020

The Standard | Dominic Omondi | Sunday, 30th August 2020

WORST SIX MONTHS FOR BANKS AS PROFIT DROPS BY 30 PER CENT

Banks are estimated to have registered a drop in profitability by 30 per cent in what is turning out to be one of the worst half years for the country's lenders. [Read More.](#)

29th August 2020

The Standard | Ken Opalo | Saturday, 30th August 2020

SHAME OF URBAN ROT ACROSS KENYA

Over the last fortnight, Kenyans have been treated to news of criminality and generalised decay in Nairobi's Kilimani area. [Read More.](#)

28th August 2020

Business Daily | Patrick Alushula | Friday, 28th August 2020

JUBILEE HALF YEAR PROFIT HOLDS FIRM AT SH1.8BN

Jubilee Holdings half-year net profit unchanged at Sh1.8 billion, defying a trend where insurers have posted losses or drop in profits in the wake of Covid-19. [Read More.](#)

27th August 2020

The Standard | Jeckonia Otieno | Thursday, 27th August 2020

BUILDING INDUSTRY HOPES FOR GROWTH AFTER COVID-19

Kenya's construction industry has faced rough times in the past four years, but Covid-19 seems to have added wind to the storm. [Read More.](#)

The Standard | Peter Theuri | Thursday, 27th August 2020

WANT TO BUY AN APARTMENT? WHAT YOU NEED TO KNOW

This principle of property law provides that asset holders have rights to not only the plot of land itself, but also the air above and the ground below. [Read More.](#)

The Standard | John Shilita | Thursday, 27th August 2020

REGION BANKS ON HOTELS BOOM TO RIDE OUT ECONOMIC SLUMP

Counties in Western Kenya are banking on the expanding hospitality industry to emerge from the economic slump occasioned by Covid-19. [Read More.](#)

The Standard | James Wanzala | Thursday, 27th August 2020

CORONAVIRUS PUSHES TENANTS TO POORER NAIROBI ESTATES

John Wanyama, 38, a teacher at a private secondary school in Nairobi's Umoja Estate, had until March this year what many would consider a comfortable life. [Read More.](#)

Daily Nation | Statement | Thursday, 27th August 2020

DOING BUSINESS - DATA IRREGULARITIES STATEMENT

Over the 17 years of its existence, the Doing Business report has been a valued tool for countries seeking to measure costs of doing business. [Read More.](#)

26th August 2020

Business Daily | John Mutua | Wednesday, 26th August 2020

KRA IDENTIFIES WEALTHY SH259BN TAX EVADERS

The Kenya Revenue Authority (KRA) detectives have identified 1,309 firms and wealthy individuals that owe it Sh259 billion, setting the stage for travel bans, asset freeze and deactivation of Personal Identification Numbers (PINs). [Read More.](#)

The Standard | Wednesday, 26th August 2020

PROPERTY REPORT: REAL ESTATE MARKET RECORDS MILD DIP AMID COVID-19 PANDEMIC

[Read More.](#)

The Standard | Dominic Omondi | Wednesday, 26th August 2020

HOUSING STARTUP IN RECEIVERSHIP

Troubled Pan African mortgage lender, Shelter Afrique, will try to salvage some money it extended to a nondescript real estate firm for construction of furnished apartments in Kisumu County. [Read More.](#)

25th August 2020

Business Daily | Patrick Alushula | Tuesday, 25th August 2020

CENTUM LAUNCHES SH7BN APARTMENTS IN KASARANI

Centum Investment real estate arm has launched a Sh7 billion real estate project to construct apartments in Kasarani, Nairobi. [Read More.](#)

24th August 2020

Business Daily | James Kariuki | Monday, 24th August 2020

FIRM PLANS SH1BN HOUSES IN DONHOLM

Go-down and general construction company Radheshyam Transport is venturing into real estate with a Sh1 billion investment in 424 residential units development in Nairobi's Donholm area. [Read More.](#)

The Standard | Dominic Omondi | Monday, 24th August 2020

VIRUS SEES GOVERNMENT TAKE SH72B TAX HIT IN FIVE MONTHS

Go-down and general construction company Radheshyam Transport is venturing into real estate. The government has lost Sh71.5 billion in taxes in the first five months since the start of the coronavirus pandemic in Kenya. [Read More.](#)

22nd August 2020

The Standard | Sarah Okuoro | Saturday, 22nd August 2020

SH4.5 BILLION HOUSING PROJECT AT TATU CITY HANDED OVER

Unity Homes has handed over keys to buyers of the first block of apartments at Unity West, one year after breaking ground on the Sh4.5 billion project at [Tatu City](#). [Read More.](#)

For more information on the **KPDA Media Weekly Review Report**, kindly contact the KPDA Secretariat on **0737 530 290** or **0725 286 689** or by emailing ceo@kpda.or.ke

